

BR/BD 75/140 R
BR/BD 90/140 R

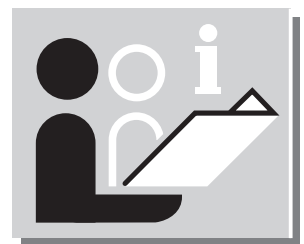

Safety instructions

Before using the unit, please read and comply with the operating instructions and the enclosed brochure "Safety instructions for brush cleaning units and spray extraction units", No. 5.956-251.

It is permitted to operate the unit on surfaces with no more than a 10 % incline.

The unit may only be operated when the dirty-water tank has been swivelled forwards and all covers have been closed.

Safety features

Safety features are intended to protect the user and must not be disconnected or bypassed.

Battery plug connection

Immediately stops all functions: pull out mains plug.

Safety switch

Switches the drive motor off if the operator leaves his seat while operating or driving the unit.

Symbols

The following symbols are used in these operating instructions:

 **Danger!** Indicates imminent danger. Non-compliance with this warning may result in death or serious injury.

 **Caution!** Indicates a potentially dangerous situation. Non-compliance with this warning may result in slight injury or damage to property.

 **Information:** Indicates application tips and important product information.

Function

The unit is used for wet-cleaning of level floors. It can easily be adjusted to a particular cleaning task by setting the water flow rate, the contact pressure of the brushes and extraction of dirty water.

An operating width of 750 mm (BR/BD 75/140 model) or 900 mm (BR/BD 90/140 model) and a 140 l fresh-water tank and dirty-water tank enable effective cleaning over a prolonged period.

The unit is self-propelled; the driving motor is powered by one battery (Trogatterie). The batteries can be charged with a battery charger connected to a 230 V socket. Battery and battery charger are supplied with the package variants.

 **Information:** The unit can be fitted with various accessories for a particular cleaning task. Ask for our catalogue or visit us on the Internet at www.karcher.com.

Appropriate use

Use this unit exclusively in accordance with the information in these operating instructions.

- The unit may be used for cleaning non-moisture-sensitive smooth floors only.
- The unit is not suitable for cleaning frozen floors (e.g. in cold-storage depots).
- The unit may be fitted with original accessories and spare parts only.
- The unit has been developed for cleaning indoor floors or covered areas. The use of alternative brushes must be tested for other application areas.
- The unit has not been designed for cleaning public highways.

Protection of the environment, disposal

After unpacking the unit, do not dispose of the packaging with your normal domestic waste.

Take the packaging components to the appropriate collection points for recycling.

Operating and control elements

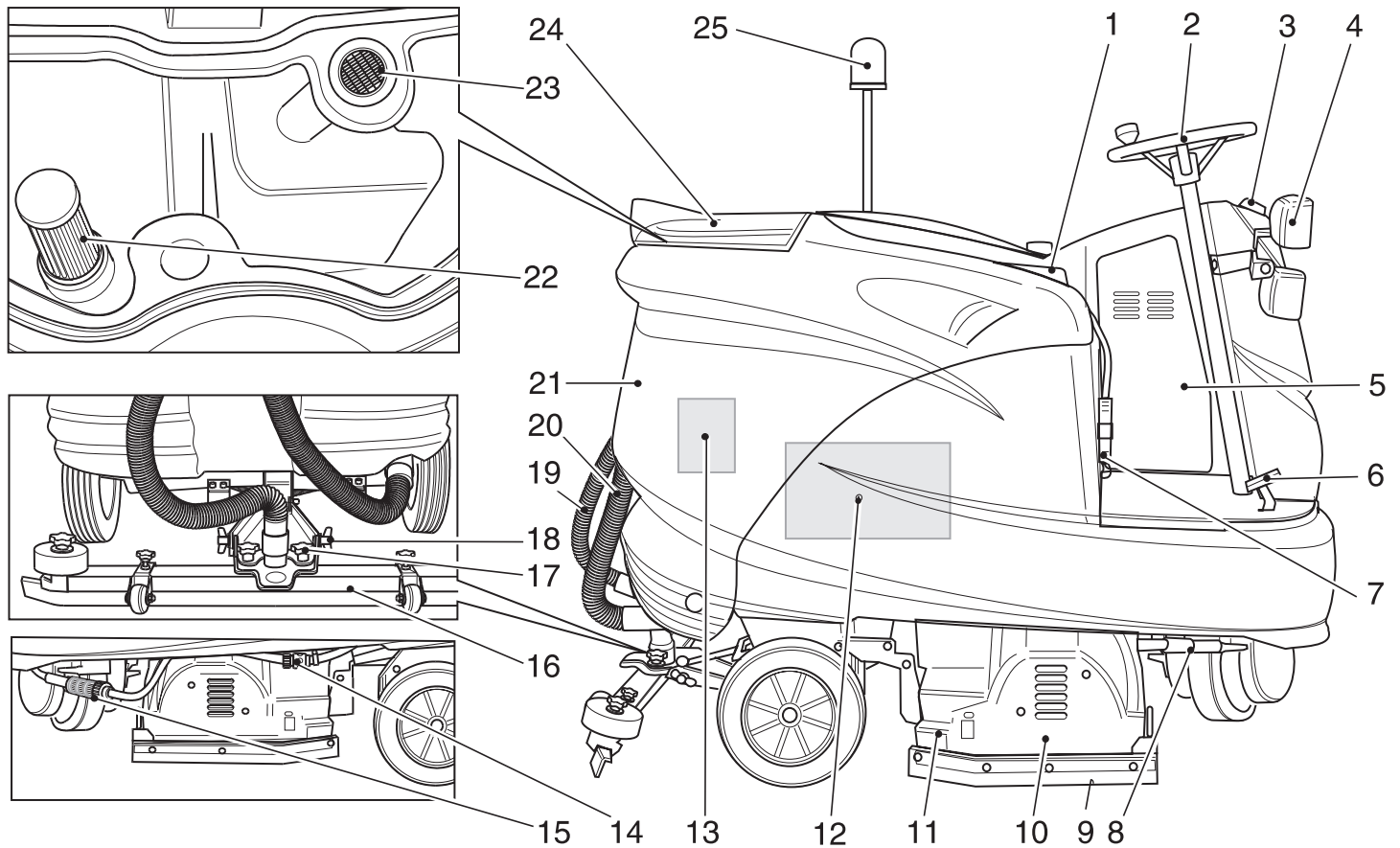

- | | | |
|---|---|---|
| 1 Seat | 9 Stripping blade | 17 Star knobs for attaching the suction bar |
| 2 Steering wheel | 10 Cleaning head | 18 Wing nuts for inclining the suction bar |
| 3 Fresh water tank inlet | 11 Coarse dirt container (only BR) | 19 Suction hose |
| 4 Light (optional) | 12 Battery | 20 Drainage hose for dirty water |
| 5 Electronics module/printed circuit board | 13 Suction motor | 21 Dirty-water tank |
| 6 Drive pedal | 14 Hose coupling for draining the fresh water | 22 Recycling filter (optional) |
| 7 Battery plug | 15 Filter fresh water | 23 Fluff strainer |
| 8 Selector switch for recycling/fresh-water mode (optional) | 16 Suction bar* | 24 Cover |
| | | 25 Warning beacon (optional) |

* not supplied with the appliance

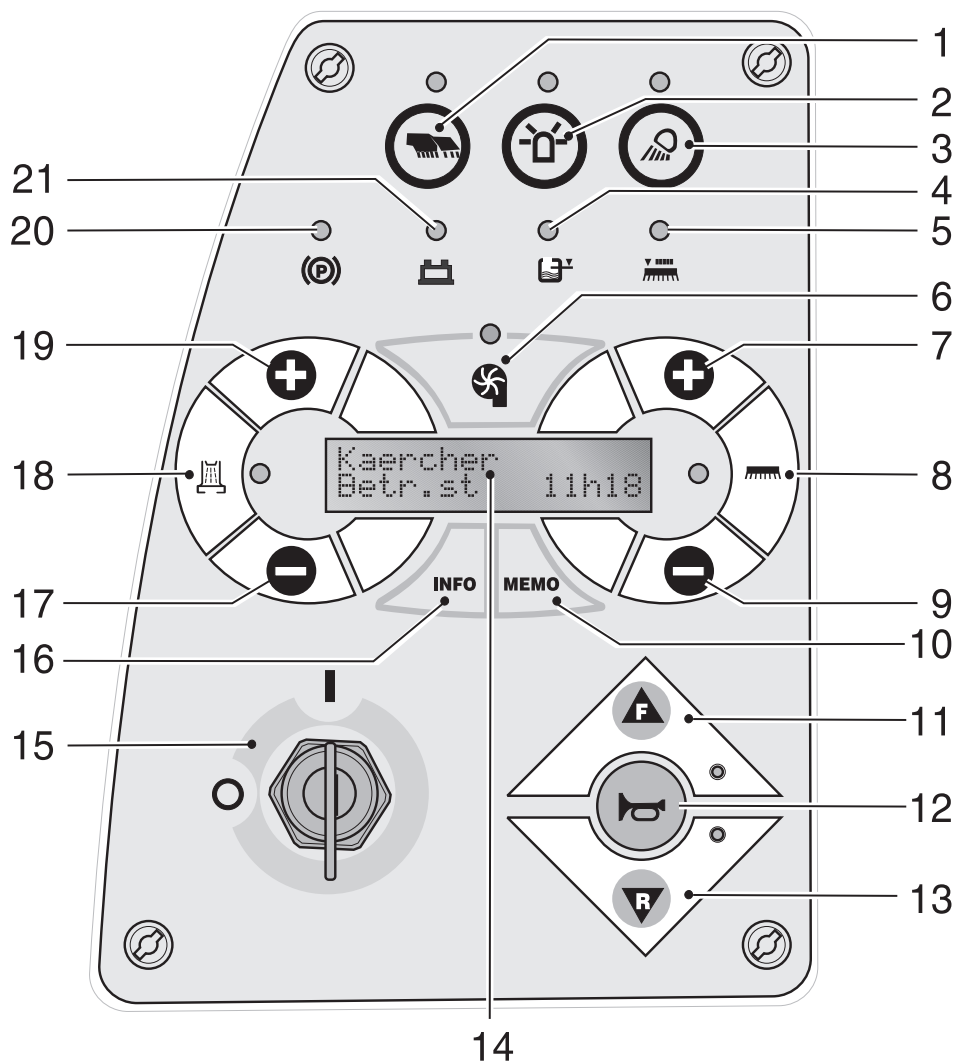

Control panel

- | | | |
|---|--------------------------------|-----------------------------|
| 1 Wall/ceiling/floor tool on/off (optional) | 8 On+lower / raise+off brushes | 16 Info Button |
| 2 Warning beacon on/off (optional) | 9 Contact pressure reduce | 17 Water flow rate reduce |
| 3 Light on/off (optional) | 10 Memo Button | 18 Water pump On/Off |
| 4 Dirty-water tank full | 11 Drive forwards | 19 Water flow rate increase |
| 5 Brush drive assembly overloaded | 12 Horn | 20 Parking brake |
| 6 Suction turbine On/Off | 13 Drive backwards | 21 Battery monitor |
| 7 Contact pressure increase | 14 Display | |
| | 15 Key switch | |

Before switching on the unit

Batteries

When handling batteries, comply with the following warning symbols:



Comply with the information on the battery, in the operating instructions and in the vehicle operating instructions.



Wear eye protection



Keep children away from acid and batteries



Danger of explosion



No naked flames, sparks or naked lights and no smoking



Risk of chemical burns



First Aid



Warning



Disposal



Do not throw the battery in the dustbin



Danger of explosion!

Do not place any tools or similar objects on the battery, i.e. on the terminals and intercell connectors.



Risk of injury!

Do not bring any wounds into contact with lead; after working with batteries, always wash hands.

Inserting and connecting batteries

The batteries are already installed in the BAT package variant.

- Swivel water tank backwards.
- Insert the battery into the container.



Caution!

Ensure that the polarity is correct!

- Clamp the supplied connection cable to the remaining free battery terminals (+) and (-).
- Swivel water tank forwards.



Caution!

Before switching on the unit, charge the batteries!

Charging the batteries



Information:

The unit features deep-discharge protection, i.e. if the still permitted minimum capacity value is reached, the brush motors and the turbine are switched off. In this case the battery monitor on the control console illuminates red. From this moment on the unit can only be driven.

- Drive the unit directly to the charging station, avoiding any inclines.



Information:

If using other batteries (e.g. another manufacturer), the deep-discharge protection for the particular battery must be re-adjusted by Kärcher customer service.



Danger of electric shock!

Note power supply system and fusing – see “Battery charger”. Never use the battery charger in rain, in high atmospheric humidity or in damp rooms!



Information:

The battery charging process lasts on average 10 hours. The recommended battery chargers (which correspond to the utilised batteries) are electronically controlled and end the charging process automatically.

Charging process



Danger of explosion!

Open the hood before charging lead-acid batteries.

- Empty the dirty-water tank.
- Swivel dirty-water tank backwards.
- Remove the battery connector and connect to the charger cable.
- Switch on battery charger.

After charging the battery:

- Switch off the battery charger and disconnect from the power supply.
- Disconnect battery cable from charging cable and connect to the unit.

Low-maintenance batteries (lead-acid batteries)

- One hour before the end of the charging process, add distilled water, ensuring that the acid level is correct. Batteries are identified accordingly. At the end of the charging process all cells must gas.



Risk of injury!

If a discharged battery is refilled with water, acid may escape!

When handling battery acid, wear protective goggles and follow the instructions to prevent injury and damage to clothing. Immediately wash off any acid splashes on the skin or clothing using plenty of water.



Caution!

Refill the batteries with distilled or demineralised water only (VDE 0510).

Do not use additives (so-called enhancing agents), otherwise any warranty will be invalidated.

Recommended batteries

Manufacturer Description	
Kärcher	Battery set
order no.	
6.654-052	

Recommended battery chargers

Manufacturer Description	
Kärcher	Battery charger
order no.	
6.654-139	

Batteries and battery chargers are available from specialist outlets.

Maximum dimensions

	Length	Width	Height
Battery set	620 mm	430 mm	467 mm
(container)			

The following is to be observed if lead-acid batteries are used in the BAT variant:

- Observe the maximum battery dimensions.
- The tank must be folded open while charging lead-acid batteries.
- When charging lead-acid batteries, comply with the regulations of the battery manufacturer.

Unloading from the pallet

Risk of injury!
Immediately stops all functions:
remove red battery connector

- Three floor boards on the pallet are attached with screws. Unscrew these boards.
- Place boards along the edge of the pallet. Align the boards in front of the wheels of the unit. Attach the boards with the screws.

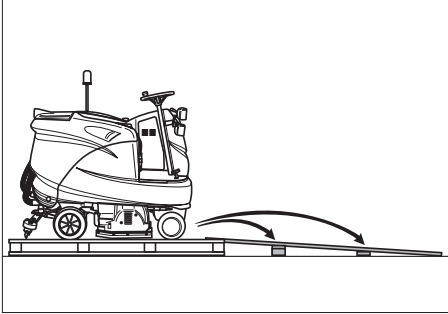

- Place the support beams, enclosed with the packaging, under the ramp.
- Remove the wooden laths.
- Plug in the battery plug.
- Set the key-operated switch to "I".
- Press "Direction-of-travel" pushbutton and slowly run the unit down the ramp.
- Set key switch back to "O".

Attaching the brushes

BD model

Before switching on the unit, the disc brushes must be attached (see "Maintenance procedures").

Attaching the suction bar

- Insert the suction bar into the suction-bar suspension device, ensuring that the profiled sheet is situated over the suspension device.
- Tighten the star knobs.

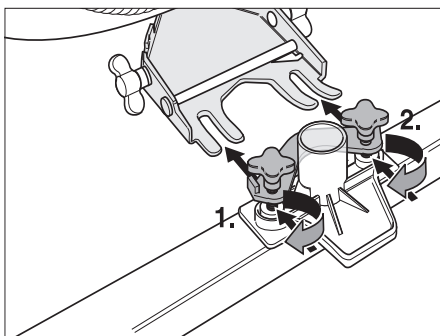

- Attach the suction hose.

Operation

Risk of injury!
Immediately stops all functions:
remove red battery connector

Driving

Caution!
Get used to your unit by test-driving it in an open space.
Drive up/down slopes at low speed only.

Information:
The unit is designed with the brush head projecting from the right side, enabling the operator to clean up to the very edge.

- Sit on the unit and set the key switch to "I".
- Set the direction of travel with the "Direction-of-travel" buttons on the control panel.
- Specify the driving speed by depressing the drive pedal. While the unit is moving, the speed is indicated on the display panel.
- To stop the unit: release the drive pedal.

Adding detergent

Caution!
Use the recommended detergents only. If other detergents are used, the operator increases the risk of malfunctions and accidents.
Detergents must not contain solvents, hydrochloric acid or hydrofluoric acid.

Information:
Do not use detergents which foam vigorously.
Before switching on the unit for the first time, completely fill the fresh-water tank in order to vent the water line system.

Working without recycling mode

If cleaning in hygienic areas (e.g. hospitals, food companies) and if giving very dirty floors a basic cleaning.

- Undo the catch on the fresh-water tank.
- Fill with fresh water (maximum 60 °C) up to the lower edge of the filler inlet
- Add detergent.
Comply with the metering information.

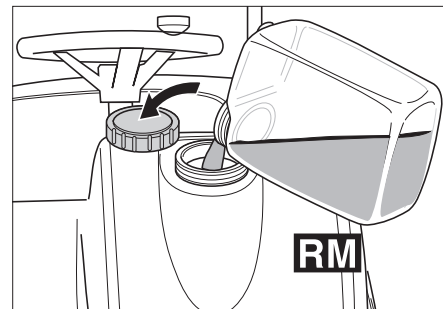

- Close the catch on the fresh-water tank.

Working in recycling mode (optional)

For cleaning slightly to normally dirty floors. Detergent and setting-up times are reduced in recycling mode.

- When the fresh-water tank is empty and the dirty-water tank is full, switch over to recycling/fresh-water mode at the rear of the unit.

Information:
Dirty water is filtered before being re-used.

If the fresh water goes directly into the dirty-water tank, recycling mode can be actuated at the start of the cleaning process.

Recommended detergents

Application:	Detergent
Maintenance cleaning (also for alkaline-sensitive RM 746 floors)	RM 745 RM 746
Cleaning greasy dirt deposits	RM 69 ES ASF RM 69 ASF
Basic cleaning (stripping) alkaline-resistant hard floor coverings	RM 752
Basic cleaning stripping linoleum	RM 754
Sanitary cleaner	RM 25 ASF
Disinfectant cleaner	RM 732

Detergents are available from specialist outlets.

Switching on the water pump

- Press the water pump On/Off button.
If the brush head has been switched on, the water pump switches on when the unit moves off.

Setting the water flow rate

- Press the increase the water flow rate button or the reduce the water flow rate button. The display indicates the current setting as a bar chart.

i Information:
The surface must be cleaned several times depending on the degree of dirt.

Lowering the suction bar

- Press the suction turbine On/Off button. The suction bar is lowered and the suction motor switches on.

! Caution!
To clean tiled floors, adjust the straight suction bar so that it is not at right angles to the crevices.
When the dirty-water tank is full, the suction turbine automatically switches off and the "Dirty-water tank full" display illuminates.

i Information:
When driving backwards, the suction bar automatically rises. To improve the vacuuming result, the suction bar can be rotated or tilted (see "Setting the suction bar").

Switching on the brush head

! Caution!
To prevent damage to the floor, do not operate the unit on the spot.

- Press the "On+lower / raise+off brushes" button. The brush head is switched on and lowered as soon as the unit starts moving. When the unit stops, the brush head is raised and switched off after an adjustable time.

Adjusting the contact pressure

- Press the increase the contact pressure button or the reduce the contact pressure button. The display indicates the current setting as a bar chart.

If the display shows that the "brush drive is overloaded", the contact pressure must be reduced. If the contact pressure is not reduced, the brush drive automatically switches off after a short time.

i Information:
Start cleaning at a low contact pressure. Gradually increase the contact pressure until the desired cleaning result is obtained.

A correctly set contact pressure reduces the energy requirement and brush wear. If the machine stops, the brush motors stop after the set time has expired. If the brush drive is overloaded, the "Brush drive overloaded" indicator light illuminates. To restart the brush drive, switch the key switch off and on again and reduce the contact pressure.

! Caution!
The brush contact pressure must not be set too high for polishing.

Memo button

The Memo button simplifies starting up the unit. The following functions are started by pressing a button:

- The suction motor is switched on and the suction beam is lowered.
- The water pump switches on when the unit moves off.
- The cleaning head is switched on and lowered when the unit moves off.

Stopping and switching off the unit

- While the unit is moving, press the Memo button and continue driving:
 - Water pump switches off.
 - The cleaning head is raised and switched off.
 - The suction beam is raised.
 - The suction motor continues running for another 10 seconds to suck up any water which has already been discharged.
- If required, the individual functions can also be ended by pressing the "Water pump on/off" and "On+lower / raise+off brushes" buttons and suction beam on+lower / off+raise buttons.
- Set the key-operated switch on the control console to "O" and remove the key.

Info button

When the unit is at a standstill, the total operating time is indicated on the lower display line. When the Info button is pressed, the current battery voltage is indicated in volts.

Draining the dirty water

! Caution!
Observe local regulations for the treatment of waste water.

- Take the drainage hose out of the holder and place in a suitable receptacle. Drain off the dirty water by opening the metering equipment. Then rinse out the dirty-water tank with fresh water.

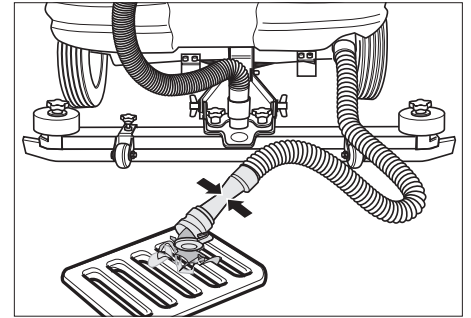

Drain off the fresh water.

- Switch over from recycling/fresh-water mode (optional) to fresh-water mode (swivel forwards).
- Disconnect the hose coupling for draining the fresh water and hold over a suitable collecting point. The process can be accelerated by switching on the water pump.

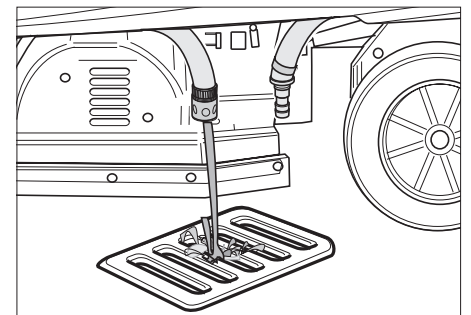

Adjusting the suction bar

Rotating the suction bar

To improve the pick-up result on ceramic floors, the suction bar can be rotated by up to 5°:

- Loosen the star knobs.
- Rotate the suction bar.

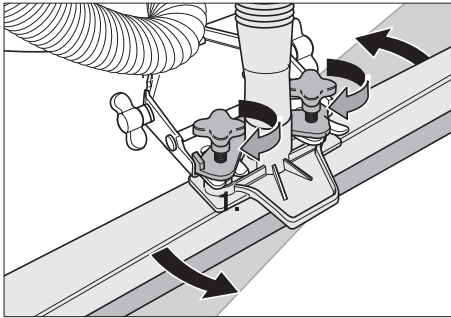

- Tighten the star knobs.

Tilting the suction bar

If the suction result is unsatisfactory, the straight suction bar can be tilted.

- Loosen the wing nuts.
- Tilt the suction bar.

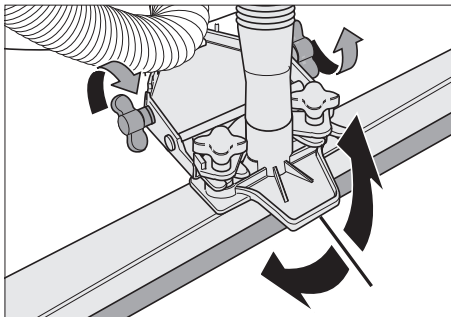

- Tighten the wing nuts.

Care and maintenance

Risk of injury! Before performing any work on the unit, turn the key switch to "O" and remove the key. Remove the battery connector.

- Drain and dispose of dirty water and any remaining fresh water.

Maintenance schedule

After work

Caution! Do not spray the unit with water or use any aggressive detergents.

- Drain off the dirty water.
- Rinse out the dirty-water tank with fresh water.
- Check the fluff strainer and, if required, clean.

- Only BR model: Take out and empty the coarse-dirt container.
- Clean the outside of the unit with a damp cloth soaked in a mild detergent solution.
- Clean squeegee and stripping blades, check for wear and, if required, replace.
- Check the brushes for wear and, if required, replace.

Monthly

- Check the battery terminals for oxidation and, if required, lubricate with terminal grease. Ensure that the connection cables are secure.
- Check that the automatic parking brake functions.
- Check the condition of the seals between the dirty-water tank and cover and, if required, replace.
- If non-maintenance-free batteries are used, check the acid concentration of the cells.
- Clean the brush tunnel.

Annually

- Have customer service conduct the stipulated inspection.

Maintenance work

Replacing the squeegee blades

- Unscrew the star knobs.

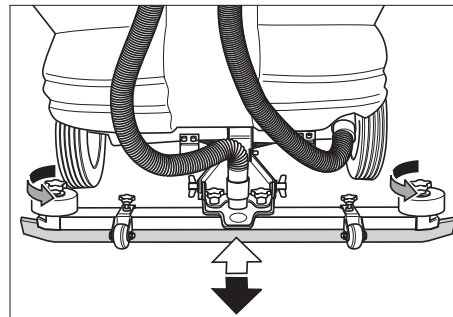

- Pull off the plastic parts.
- Remove the squeegee blades.
- Insert new rubber strips.
- Push on the plastic parts.
- Screw in and tighten the star knobs.

Replacing the roller brushes

- Loosen the wing nuts.
- Remove the bearing cover.

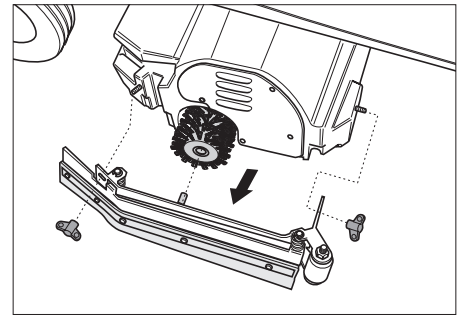

- Remove roller brush, insert new one (note hexagon fixtures for the roller brushes).

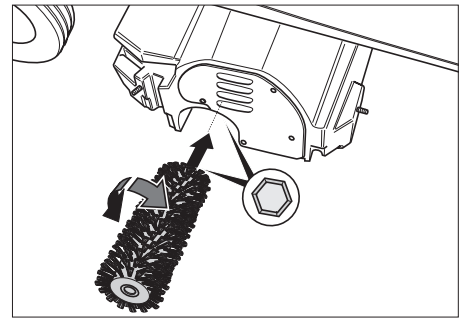

- Attach bearing cover.
- Tighten the wing nuts.
- Repeat procedure on the opposite side.

Replacing disc brushes

- Raise the disc brushes.
- Rotate disc brushes by approx. 45° in an anti-clockwise direction.
- Pull down and remove disc brushes.
- Insert the new disc brushes in reverse sequence.

Maintenance agreement

To ensure that the unit operates reliably, maintenance agreements can be concluded with the appropriate Kärcher sales office.

Frost protection

If there is a risk of frost

- Drain the fresh-water and dirty-water tanks.
- Put the unit in a room which is protected from frost.

Transport

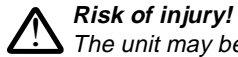

Risk of injury!

The unit may be loaded and unloaded on max. 10 % inclines only.

- If transporting the unit by vehicle, secure the unit with tension belts/ropes to prevent it from sliding.

BD model

- Remove the disc brushes from the brush head.

Troubleshooting



Risk of injury!

Before performing any work on the unit, turn the key switch to “O” and remove the key. Remove the battery connector.

- Drain and dispose of dirty water and any remaining fresh water.

If faults cannot be rectified with the aid of this table, contact customer service.

Changing the fuses

The printed circuit board is attached under the control panel. To gain access to the fuses, the cover on the left side of the footwell must be removed beforehand.

- Unscrew the retaining screw on the cover.
- Change the fuse.
- Re-attach the cover.



Information:

The fuse configuration is indicated on the inside of the cover.

Faults indicated on display		
Display	Cause	Remedial action
Fehler! Sitzschalter Error! seat switch	Seat contact switch has not been activated.	The unit will not function unless a person is on the seat. If the fault still occurs, call customer service.
Tank voll tank full	Dirty water tank is full.	Empty dirty water tank. If the fault still occurs, call customer service.
Überlast Fahrmotor Overload traction motor	Current consumption of the traction motor is too great e.g. motor blockage or traversing excessively steep ramp.	1. Set key switch to “O”. 2. When the display has switched off, wait briefly. 3. Then set to “I” again. If the fault still occurs, call customer service.
Fehler! Sicherung Fahrt Error! Fuse, traction	Traction motor fuse defective.	Change F2 fuse, observing stipulated value. * If the fault still occurs, call customer service.
Überlast Bürstenmotor Overload brush motor	Current consumption of the brush motor is too great	1. Set key switch to “O”. 2. When the display has switched off, wait briefly. 3. Then set to “I” again.
	e.g. contact pressure too great	4a. Before switching on the brush, reduce the brush contact pressure.
	or brush blocked	or 4b. Remove the brush and eliminate the cause of the blockage.
Fehler! Sicherung Bürste Error! Fuse, brush	Brush motor fuse defective.	Change F3 fuse, observing stipulated value. * If the fault still occurs, call customer service.
Fehler! Bürstenanhebung Error! Brush lifting	Current consumption of the lifting motor too great.	1. Set key switch to “O”. 2. When the display has switched off, wait briefly. 3. Then set to “I” again. If the fault still occurs, call customer service.
Fehler! Endschalter Error! limit switches	a) Limit switches have shifted. b) Cabling is defective.	Call customer service.

* The fuses are situated on the printed circuit board and can be accessed by opening the cover.

Faults indicated on display		
Display	Cause	Remedial action
Fehler! Sicherung Turbine Error! Fuse, vacuum	Vacuum motor fuse defective.	Change F4 fuse, observing stipulated value. * If the fault still occurs, call customer service.
Überlast Turbine Overload vacuum motor	Vacuum motor current too great e.g. motor blockage.	1. Set key switch to "O". 2. When the display has switched off, wait briefly. 3. Then set to "I" again. If the fault still occurs, call customer service.
Fehler! Wasserpumpe Error! Water pump	Electronic fuse has tripped.	
Fehler! Bremse Error! Brake		
Fehler! Arbeitslicht Error! Front light	Electronic fuse has tripped.	1. Set key switch to "O". 2. When the display has switched off, wait briefly. 3. Then set to "I" again. If the fault still occurs, 4. check the halogen lamp 5. if required, change. If the fault still occurs, 6. call customer service.
Fehler! Rundumleuchte Error! Rotating beacon		
Fehler! Fehlstart Error! Incorrect start	The key switch was set to "I" while the accelerator was depressed.	Before switching on the key switch, remove foot from accelerator.
Fehler! Fahrtrichtung Error! Traction dir.	When the key switch is switched on, there is no preselected traction direction when the accelerator is depressed.	Select the required traction direction (forwards / backwards).
Fehler! Gaspedal Error! Accelerator	The control detects no plausible accelerator signal. Cable break.	Call customer service.

* The fuses are situated on the printed circuit board and can be accessed by opening the cover.

Faults not indicated on display	
Fault	Remedial action
Unit cannot be started.	Plug in the battery plug.
	Set the key-operated switch to "I".
	Check fuses F1 and F2 and, if required, replace. *
	Check batteries; if required, charge.
Unit does not move.	Check fuse F2; if required, replace. *
Inadequate water flow rate.	Check fresh-water level; if required, top up tank.
	Check hoses for blockages; remove any blockages.
	Clean the filter for fresh water.
Inadequate suction power.	Check fuse F4; if required, replace. *
	Clean the seals between the dirty water tank and cover, check for leaks and, if required, replace.
	Clean the fluff strainer on the intake neck of the suction motor.
	Clean squeegee blades on the suction bar; if required, replace.
	Check suction hose for blockages; remove any blockages.
	Check suction hose for leaks; if required, replace.
	Check whether cover on the dirty-water drainage hose is closed.
	Check the setting of the suction bar.
Unsatisfactory cleaning result.	Adjust contact pressure.
	Check brushes for wear; if required, replace.
Brushes do not rotate.	Reduce contact pressure.
	Check whether the brushes are blocked by foreign objects; if required, remove foreign objects.
	Check fuse F3; if required, replace. *

* The fuses are situated on the printed circuit board and can be accessed by opening the cover.

Accessories

Designation	Part no. BR 75/140	Part no. BR 90/140	Description	Quantity	Quantity required for unit BR 75 (BR 90)
Brush roller, white (standard)	5.762-285	6.906-007	for maintenance cleaning of very dirty floors	1	2
Brush roller, black (soft)	6.906-496	6.906-010	for polishing and for maintenance cleaning of sensitive floors	1	2
Brush roller red (high/low)	6.906-495	6.906-009	for scrubbing of structured floors (safety tiles, etc.)	1	2
Brush roller, grey (hard)	6.906-494	6.906-008	for basic cleaning of very dirty floors and for removal of coatings (e.g. wax, acrylates)	1	2
Brush roller, grey (very hard)	6.906-497	6.906-252		1	2
Pad roller shaft	4.762-316	4.762-189	for housing roller pads	1	2
Roller pad (white)	6.369-389	6.369-389		20	2 (3)
Roller pad (red)	6.369-456	6.369-456	for cleaning of slightly dirty floors	20	2 (3)
Roller pad (green)	6.369-455	6.369-455	for cleaning of normal to very dirty floors	20	2 (3)
Roller pad (yellow)	6.369-454	6.369-454	for polishing of floors	20	2 (3)

Designation	Part no. BD 75/140	Part no. BD 90/140	Description	Quantity	Quantity required for unit BD 75 (BD 90)
Disc brushes, natural	6.369-492	6.906-056	for polishing of floors	1	1
Disc brush, white	6.906-346	6.906-054	for cleaning of slightly or sensitive floors	1	1
Disc brush, grey grit	6.906-491	6.906-055	for cleaning of very dirty floors	1	1
Driving plate	6.906-493	6.906-332	for housing pads	1	1
Disc pad (red)	6.369-791	6.369-024	for cleaning of slightly dirty floors	5	1
Disc pad (green)	6.369-790	6.639-023	for cleaning of very dirty floors	5	1
Disc pad (black)	6.369-789	6.369-022	for cleaning of very dirty floors	5	1
Rubber squeegee, grey	6.273-214	6.273-214	Standard	pair	1 pair
Rubber squeegee, oil-resistant	6.273-208	6.273-208	oil-resistant	pair	1 pair
Suction bar, straight	4.777-049	4.777-049	Standard	1	1
Suction bar, curved	4.777-056	4.777-056	Standard	1	1
Rubber squeegee, floor working head	5.394-640	5.394-640		1	2

Technical Specifications

	Unit	BR 75/140 R (BR 90/140 R)	BD 75/140 R (BD 90/140 R)
Power			
Nominal voltage	V	24	24
Battery capacity	Ah (5h)	400	400
Power consumption	W	2800 (3100)	2800 (2800)
Driving motor output	W	600	600
Suction motor power	W	800	800
Brush motor power	W	2 x 600 (2 x 750)	2 x 600 (2 x 600)
Suction			
Suction power, air flow rate	l/s	28	28
Suction power, vacuum	mbar	140	140
Cleaning brush			
Operating width	mm	750 (900)	750 (900)
Diameter, brush roller	mm	110	400 (460)
Brush speed	1/min	1300	180
Dimensions and weight			
Max. driving speed	km/h	6	6
Max. gradient	%	10	10
Theoretical surface performance	m ² /h	3000	3600
Volume, fresh/dirt-water tanks	l	140/140	140/140
Length	mm	1550 (1550)	1550 (1550)
Width	mm	870 (940)	870 (940)
Height	mm	1340 (1340)	1340 (1340)
Weight (with/without batteries)	kg	550/230	550/230
Noise emission			
Average sound pressure level in compliance with EN 60704	dB(A)	70	70

EU Declaration of Conformity

We hereby declare that the equipment described below conforms to the relevant fundamental safety and health requirements of the appropriate EU Directives, both in its basic design and construction as well as in the version marketed by us.

This declaration will cease to be valid if any modifications are made to the machine without our express approval.

Product: **Ride-on floor cleaning unit**

Model: **1.246-xxx**

Relevant EU Directives:

EU Machinery Directive (98/37/CE)

EU Low-Voltage Equipment Directive (73/23/EEC) amended by 93/68/EEC

EU Directive on Electromagnetic Compatibility (89/336/EEC) amended by 91/263/EEC, 92/31/EEC, 93/68/EEC

Harmonised standards applied:

DIN EN 60.335-1

DIN EN 60.335-2-29

DIN EN 60 335-2-72

DIN EN 61 000-2-3: 2000

DIN EN 61 000-3-3: 1995+A1: 2001

DIN EN 55.014-2:1997

DIN EN 55 014-1: 2000+A1:2001

National standards applied: –

Appropriate internal measures have been taken to ensure that series-production units conform at all times to the requirements of current EU Directives and relevant standards.

The signatories are empowered to represent and act on behalf of the company management.

i.U. Reiser *Jen*

S. Reiser

H. Jenner

Alfred Kärcher GmbH & Co.
Cleaning Systems
D-71349 Winnenden

Alfred Kärcher Kommanditgesellschaft.
Sitz Winnenden;
Registergericht: Waiblingen, HRA 169.
Persönlich haftende Gesellschafterin:
Kärcher Reinigungstechnik GmbH;
Sitz Winnenden, 2404 Registergericht
Waiblingen, HRB
Geschäftsführer: Dr. Bernhard Graf,
Georg Metz, Hartmut Jenner,
Thomas Schöbinger

Warranty

The warranty terms issued by our authorised marketing company are valid in every country. We remedy any fault in the cleaner free of charge within the warranty period providing the cause of the fault proves to be a material or manufacturing error.

If making a claim under the guarantee, please consult your dealer or local authorised customer service centre and provide your receipt of purchase.

Battery charger (package model)

Safety instructions

Please read and comply with the operating instructions before using the battery charger.

Also comply with the instructions supplied by the battery manufacturer.

Keep children away from batteries and the battery charger.

Do not change the plug on the battery charger.

The battery charger may be used with the recommended batteries only. If incorrect batteries are connected to the battery charger, the batteries may gas excessively, boil and explode.

The battery charger may be operated only in the installation location specified by the factory.

Appropriate use

Use this battery charger exclusively in accordance with the information in these operating instructions.

- The battery charger may only be used for charging undamaged lead traction batteries.
- The battery charger may be used only for low-maintenance lead drive batteries at a mains voltage of 24 volts.
- The battery charger may be operated with the following line-side fusing: min. 10 A gL fuse or min. 10 A thermal fuse cut-out at least 10 A (B or C characteristic).

Indicator lights

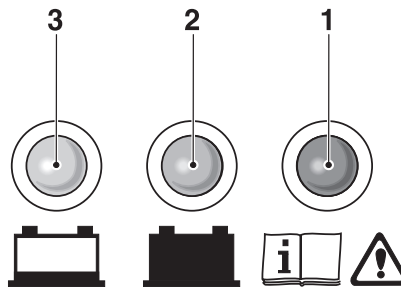

- 1 Red LED illuminates = battery charger/ battery fault, inform customer service
- 2 Green LED illuminates = batteries fully charged
- 3 Yellow LED illuminates = batteries are being charged

Switching on the unit

⚠ Danger of explosion!
Do not operate batteries outdoors, on highways, in potentially explosive rooms or in rooms containing electrically conductive dust.

Explosive gases can occur when batteries are being charged. Do not smoke, use naked flames or generate sparks near batteries or the battery charger!
When charging batteries, do not cover the air slots on the battery charger. Open the hood of the cleaning unit during the charging process.

- Connect the mains plug on the battery charger to an earthed 230 V mains socket. The charging process begins automatically.

Maintenance

The battery charger is maintenance-free. As some parts are subject to wear, we recommend having the battery charger checked regularly by an electrician.

The battery charger may be opened and repaired by an electrician only. Please consult your customer service.

Technical Specifications

Mains voltage	220–230 V, 50 Hz
Output voltage	24 V
Output current	max. 50 A
Charging characteristics	IU1a with equalising charge
Ambient temperature.	0–40 °C
Air humidity	0–90 %, not condensing
Weight	5,5 kg
Degree of protection	IP 20
Class of protection	I
Dimensions (H x W x D)	85 x 219 x 308 mm

KÄRCHER BR-BD 75/140 - 90/140

- 1.246-101 BR 75/140 R *EUR
- 1.246-121 BR 75/140 R PACK EUR*
- 1.246-201 BD 75/140 R *EUR
- 1.246-221 BD 75/140 R PACK *EUR
- 1.246-301 BR 90/140 R *EUR
- 1.246-321 BR 90/140 R PACK *EUR
- 1.246-401 BD 90/140 R *EUR
- 1.246-421 BD 90/140 R PACK *EUR

